

BANK BRANCH

Install PQ Global Voltage Surge Protection!

Is your Bank Branch protected against voltage transients?



Effects of Transients on Bank Branches:

-  Downtime/Revenue Loss
-  ATM Damage
-  Server Damage
-  Security Equipment Damage

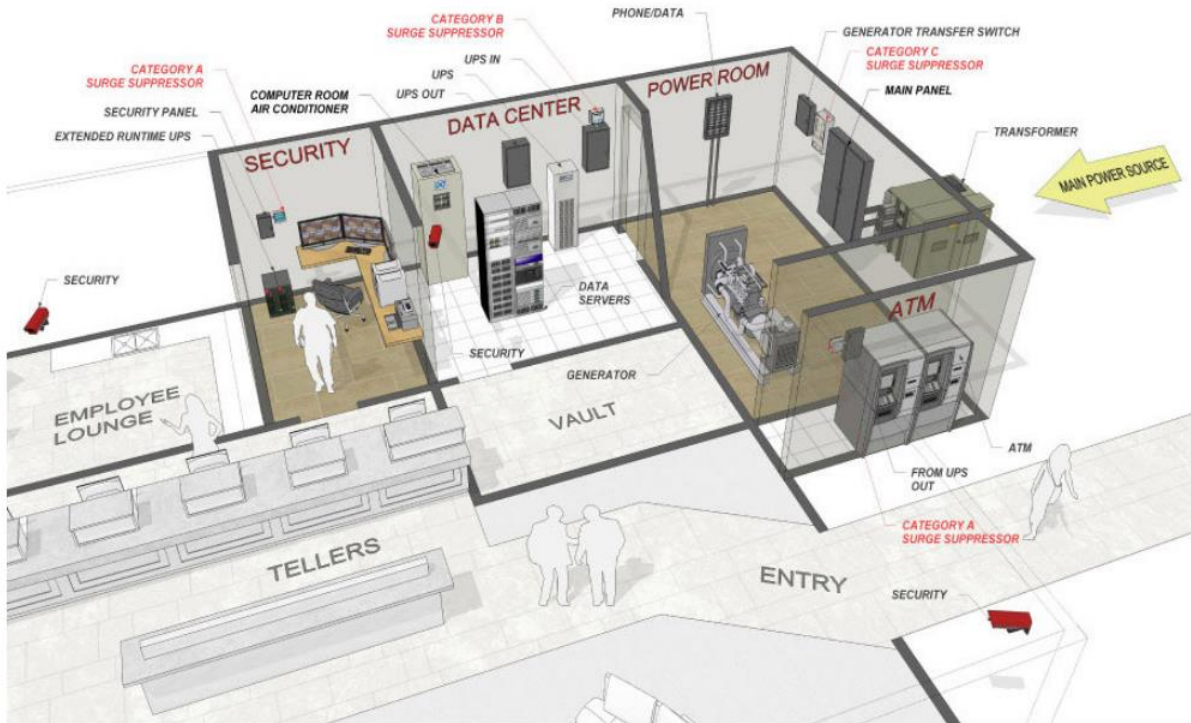

Quick guide for Bank Branch equipment protection from voltage transients

Selecting the correct transient protection for your installation is easy:

CATEGORY C (Service Entrance)

XAS – 500, 400, 300 KA

CATEGORY B (Branch Panel)

XDS – 150 or 200 KA

CATEGORY A (Point of Use)

SPDee -50 KA



Specific equipment to protect:

SERVERS / COMPUTERS

ATMs

SECURITY CAMERAS/ RECORDERS

UNINTERRUPTIBLE POWER SYSTEM (UPS)

ELECTRONIC CONTROLS

MODEL	CAPACITY/PHASE	RESPONSE TIME	DIMENSIONS (inches, HxLxW)	WEIGHT
SPDee	50 KA	< 1 ns	3.26 x 3.31 x 3.26	1.6 lbs
XDS	150 KA	< 1 ns	6 x 6 x 4	5 lbs
XDS	200 KA	< 1 ns	6 x 6 x 4	5 lbs
XAS	300 KA	< 1 ns	12 x 12 x 7.5	25 lbs
XAS	400 KA	< 1 ns	12 x 12 x 7.5	25 lbs
XAS	500 KA	< 1 ns	12 x 12 x 7.5	25 lbs

10 Year Warranty

(on workmanship and materials)

UL1449 4th Edition File: VZCA2.E321351 at
www.UL.com
 CUL, UL 1283, ANSI/IEEE C62.41.2-2002, and
 C62.45-2002
 IEC 61643, CE
 RoHS Compliant
 Made in USA



CONTACT US

(858) 271-5996

info@pqglobal.com